

**Unilumin**

LED SOLAR LIGHTING  
SERIES



**SunMaster  
ELite**

Illuminate Every Step of Your Way

**Unilumin**

TOGETHER, FOR A BRIGHTER FUTURE

**UNILUMIN GROUP CO., LTD**

**HQ Address:** 112 Yongfu Rd., Qiaotou Village, Fuyong Town, Baoan District, Shenzhen 518103 China

**Manufacturing Base:** Unilumin Industrial Park, 6 North Lanjing Road Pingshan District, Shenzhen, China

**TEL:** +86-0755-29918999 | **FAX:** +86-0755-29912092 | **E-mail:** ledlighting@unilumin.com

**www.unilumin.com | www.unilumin-lighting.com**

The product designs and specifications are subject to change without prior notice.  
All rights reserved, copy is prohibited without the permission of Unilumin Group Co., Ltd.

**Unilumin**

## | SUNMASTER ELITE SERIES

### Product Description

SunMaster ELite solar powered LED street lights incorporate a self-contained solar power assembly sized to run the specific solar light fixture with built-in battery pack and adjustable solar panel to provide green and sustainable lighting. The series offer 30W to 80W systems for extensive outdoor off-grid lighting applications.

### Features & Benefits

- Designed to operate reliably and sustainably, bringing light to areas without access to electric grid
- Designed autonomy for 2-3 overcast days to ensure its reliable light output at night time
- Lumen packages up to 13600lm for a variety of applications
- Built-in motion sensor maximizes energy saving and prolongs working hours
- Replaceable LiFePO4 battery for long life and hassle free operations
- Adjustable mounting bracket adapts to different regions
- Easy to install and maintain, no wiring and cabling required
- Side entry and post top installations optional
- Precise and professional light distributions to enable high utilization of light
- High output lumen efficiency 170lm/W to maximize battery performance
- Auto on and off function from dusk to dawn, user-friendly
- Internal error-proof cable connections for easy component replacement

### Applications

Off-grid roads, streets, squares, residential areas, cycle path, car parks, rural areas, security lighting etc.

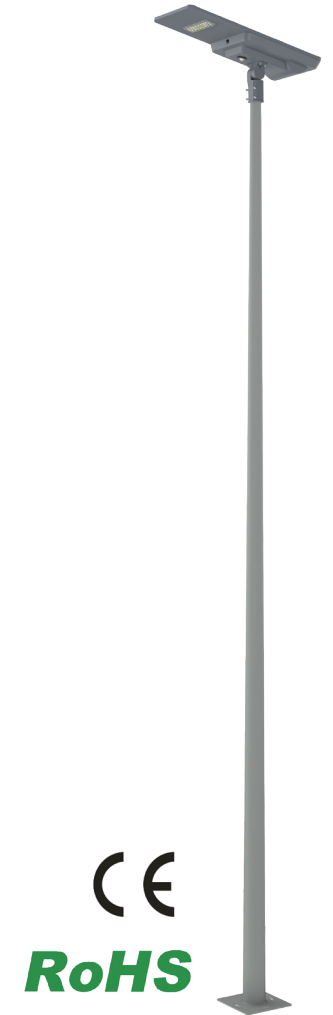

CE  
**RoHS**

## DETAILS

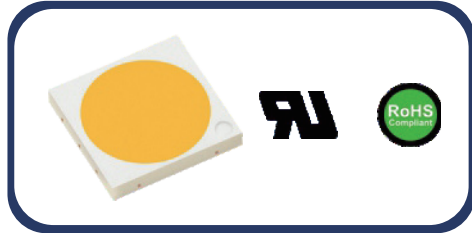

### LED Light Sources

Top quality and highly efficient LEDs provide great luminous efficacy and longer lifespan with stability and comfortable visual perception.

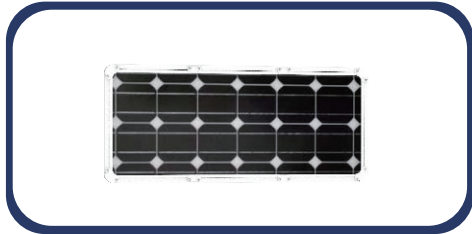

### Solar Panel

Monocrystalline solar panels, Stable photoelectric conversion efficiency, advanced diffuse technology, which can ensure the uniformity of conversion efficiency.



### LiFePO4 Battery

Highly reliable  
High capacity  
More safety,  
Withstand high temperatures 60°C  
Long lifespan, 2000 cycles.



### Efficient Controller

Highly efficient MPPT and PWM type controllers are optional with PIR and Microwave motion sensor

## DETAILS

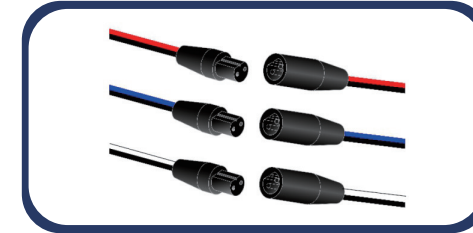

### Error-proof Connection Design

All the internal wiring of the ELite solar luminaires are quick, error-proof and waterproof plug-and-play connectors for the easy maintenance and system reliability.



### IP66 Protection

Weatherproof gasket and precise construction design guarantee IP66 rating

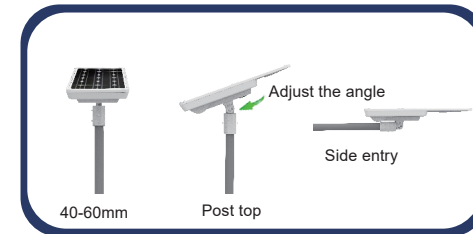

### Installation

Side entry and post top spigots for 40mm and 60mm diameter pole arm

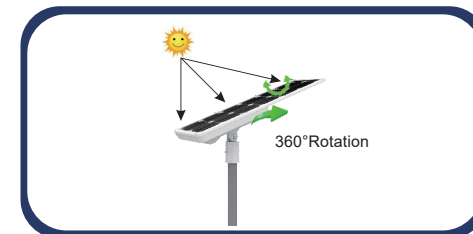

### Flexible Angle

The installation angle can be adjusted to make the solar panels face the sun and improve the charging efficiency to the greatest extent.

## DETAILS

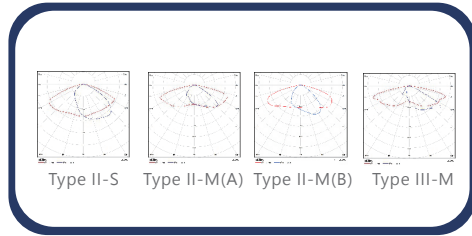

### Multiple Lenses

Optical options are available to meet the lighting needs of customers on different roads, parking lots, squares, parks, etc.

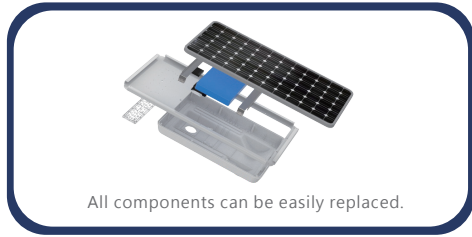

### Convenient Maintenance

All components can be easily replaced.

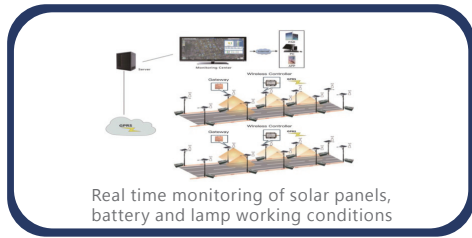

### Optional Connected Solar Lighting

Real time monitoring of solar panels, battery and lamp working conditions



### Enhanced Motion Sensor Control

Default working mode and other configuration settings available to meet different lighting requirements and save energy for storage batteries

## PARAMETERS

Product Model	UNI-SLEC-1-030	UNI-SLEC-1-040	UNI-SLEC-1-050
System Power	30W	40W	50W
Luminous Flux	5100lm	6800 lm	8500 lm
System Voltage	12V	12V	12V
LED Brand	Lumileds		
Light Distribution	II-S,II-M,III-M		
CCT	2200K~6500K		
Charge Time	6 Hours		
Working Time	2-3 Days (Auto Control)		
IP Rating	IP66		
Luminous Efficiency@5000K	170Lm/W		
Operating Temperature	-20°C to 60°C		
Warranty	3 Years		
Housing Material	Aluminum		
Battery Parameters	LiFePO4 12.8V 18AH	LiFePO4 12.8V 24AH	LiFePO4 12.8V 30AH
Solar Panel Parameters	Monocrystalline 18V 40Wp	Monocrystalline 18V 50Wp	Monocrystalline 18V 60Wp
Luminaires Dimension ( mm )	735×373×313	880×373×313	988×373×313
Packing Dimension ( mm )	825×450×165	975×450×165	1085×450×165
Net Weight ( Kg )	11.5±0.2	12.5±0.2	13.5±0.2
Gross Weight ( Kg )	13.5±0.2	15.0±0.2	16.5±0.2

## PARAMETERS

Product Model	UNI-SLEC-1-060	UNI-SLEC-1-070	UNI-SLEC-1-080
System Power	60W	70W	80W
Luminous Flux	10000lm	12000lm	13600 lm
System Voltage	24V	24V	24V
LED Brand	Lumileds		
Light Distribution	II-S,II-M,III-M		
CCT	2200K~6500K		
Charge Time	6 Hours		
Working Time	2-3 Days (Auto Control)		
IP Rating	IP66		
Luminous Efficiency@5000K	170Lm/W		
Operating Temperature	-20°C to 60°C		
Warranty	3 Years		
Housing Material	Aluminum		
Battery Parameters	LiFePO4 25.6V 18AH	LiFePO4 25.6V 24AH	LiFePO4 25.6V 24AH
Solar Panel Parameters	Monocrystalline 36V 80Wp	Monocrystalline 36V 90Wp	Monocrystalline 36V 100Wp
Luminaires Dimension ( mm )	1350×373×313	1390×373×313	1482×373×313
Packing Dimension ( mm )	1445×450×165	1490×450×165	1575×450×165
Net Weight ( Kg )	16.5±0.2	17.8±0.2	19.5±0.2
Gross Weight ( Kg )	20.3±0.2	21.8±0.2	24.0±0.2

## DIMENSIONS

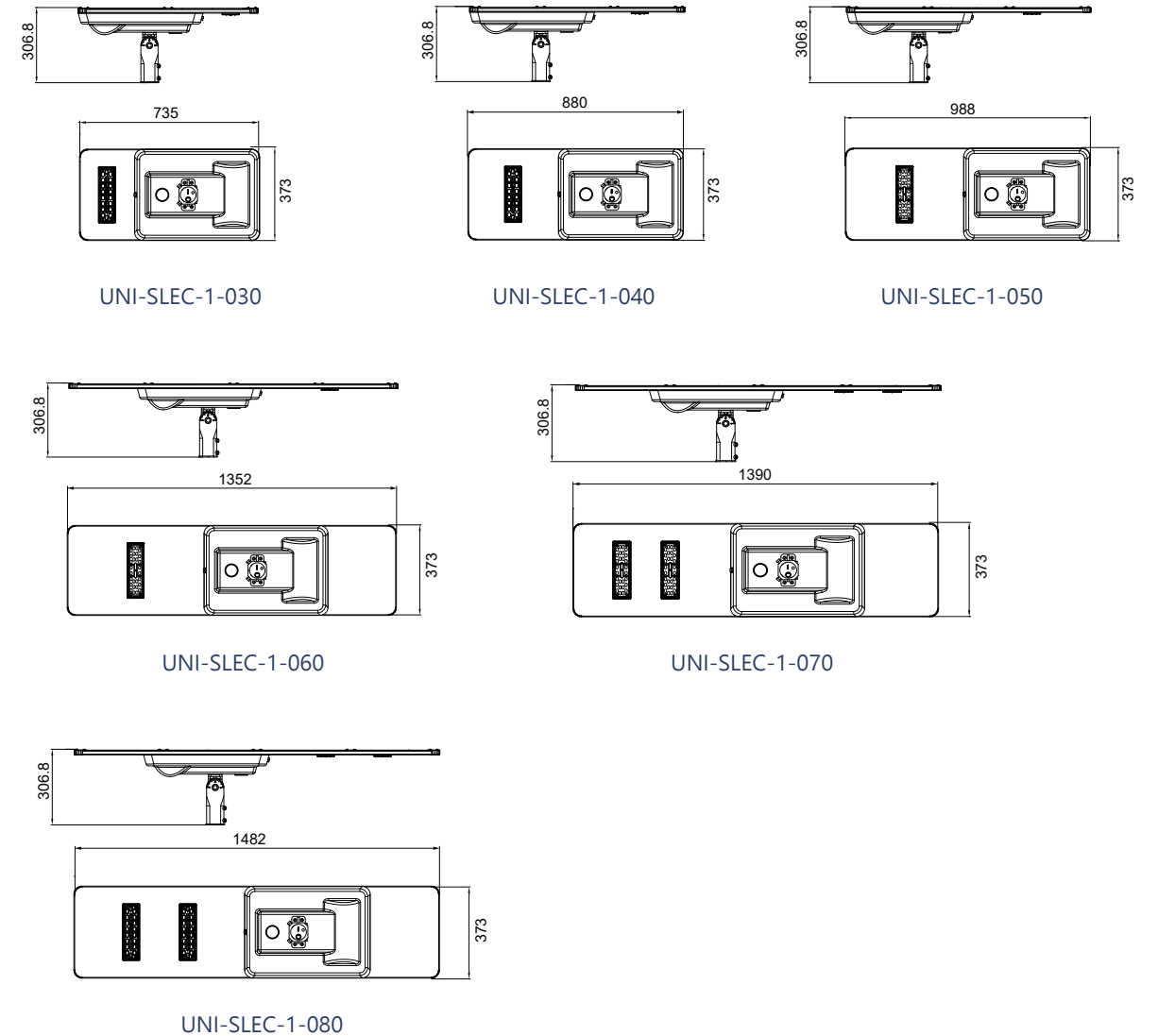



***Unilumin***